

BJB GmbH & Co. KG · Werler Str. 1 · 59755 Arnsberg · Germany
Telefon +49 2932 982-0 · Fax +49 2932 982-8201
info@bjb.com · www.bjb.com



2 in 1

PCB fixing with constant contact pressure

Reduced costs through quick and easy push-in fixing,
improved quality through permanent, uniform contact pressure

The idea is pure simplicity: straightforward push-in fixing. This is nothing new in itself. What is new is that a uniform contact pressure is achieved – permanently. In addition, thermal expansion of the PCB is offset by the material composition of the Push to Fix (P2F).

The assembly process

1

Positioning of the light fitting and the PCB

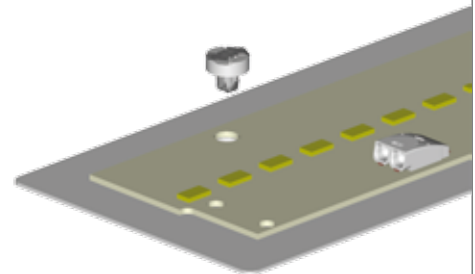

2

The P2F is pushed directly into the fixing holes provided...

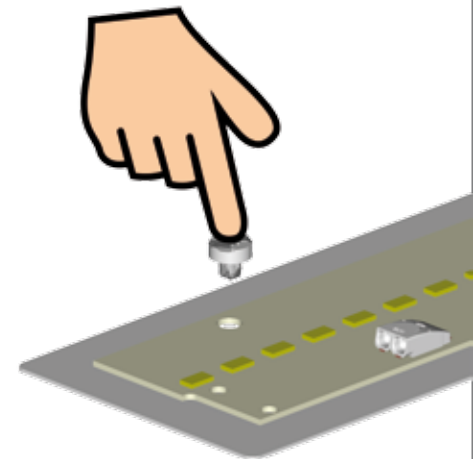

3

... and simply snaps in when pressed.*
The result is an optimum connection between PCB and light fitting.

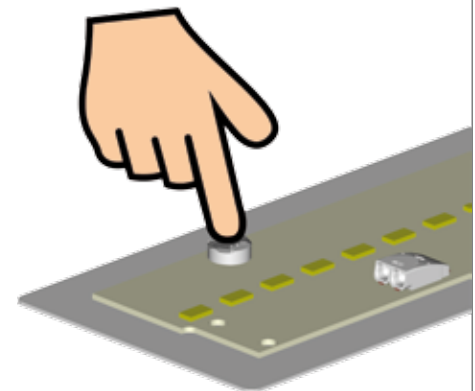

*Push-in fixing can be performed manually – with or without assembly tools. There is a choice of mechanical, pneumatic or electrical tools for this purpose. Integration into a fully automatic luminaire assembly process using ADS represents the highest application level.



28.901.U162 - 28.901.U164

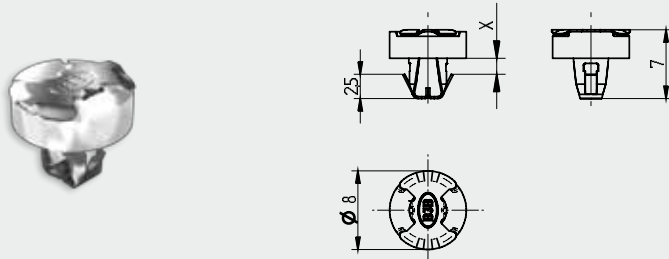

28.901.U165 - 28.901.U166

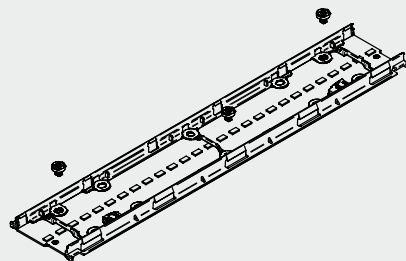
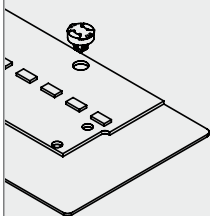
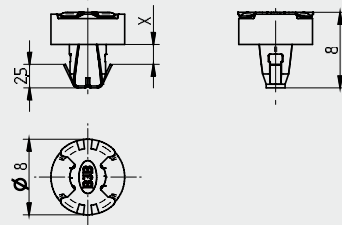

-40°C
80°C

CAD

i

98...

part no.	Thickness of PCB and panel: X	Ring-Colour-Code
28.901.U162.10	1.5 - 2.0 mm	transparent natural
28.901.U163.10	2.0 - 2.4 mm	transparent yellow
28.901.U164.10	2.4 - 2.7 mm	grey
28.901.U165.10	2.7 - 3.2 mm	white
28.901.U166.10	3.2 - 3.6 mm	blue
28.901.U169.10	4.0 mm	transparent natural

P2F - Push-to-Fix - Fixing element
 Push in fixing for mounting modules and BJB optic holder into light fitting housing
 Material: CrNi with silicon insulating ring
 Provides consistent and constant contact pressure
 Push in fixing: for hole pattern \varnothing 4.2 mm

- Quick assembly process improves production efficiency and reduces production costs
- Eliminates potential damage from screw fixing due to low insertion force
- CrNi and silicone materials ensure long life reliability
- Reliable heat dissipation due to a constant pressure
- Suitable for Zhaga standardised hole sizes of \varnothing 4.7 mm in LED board to ensure future proofed designs
- Assembly without any additional tools
- Solutions for Automation upon request
- Removable connection



part no.
28.901.U801.89 Bit holder
28.901.U811.10 Bit

P2F assembly tool

- To hold one fixing element each
- P2F held by means of magnet

Smarter than screw fixing

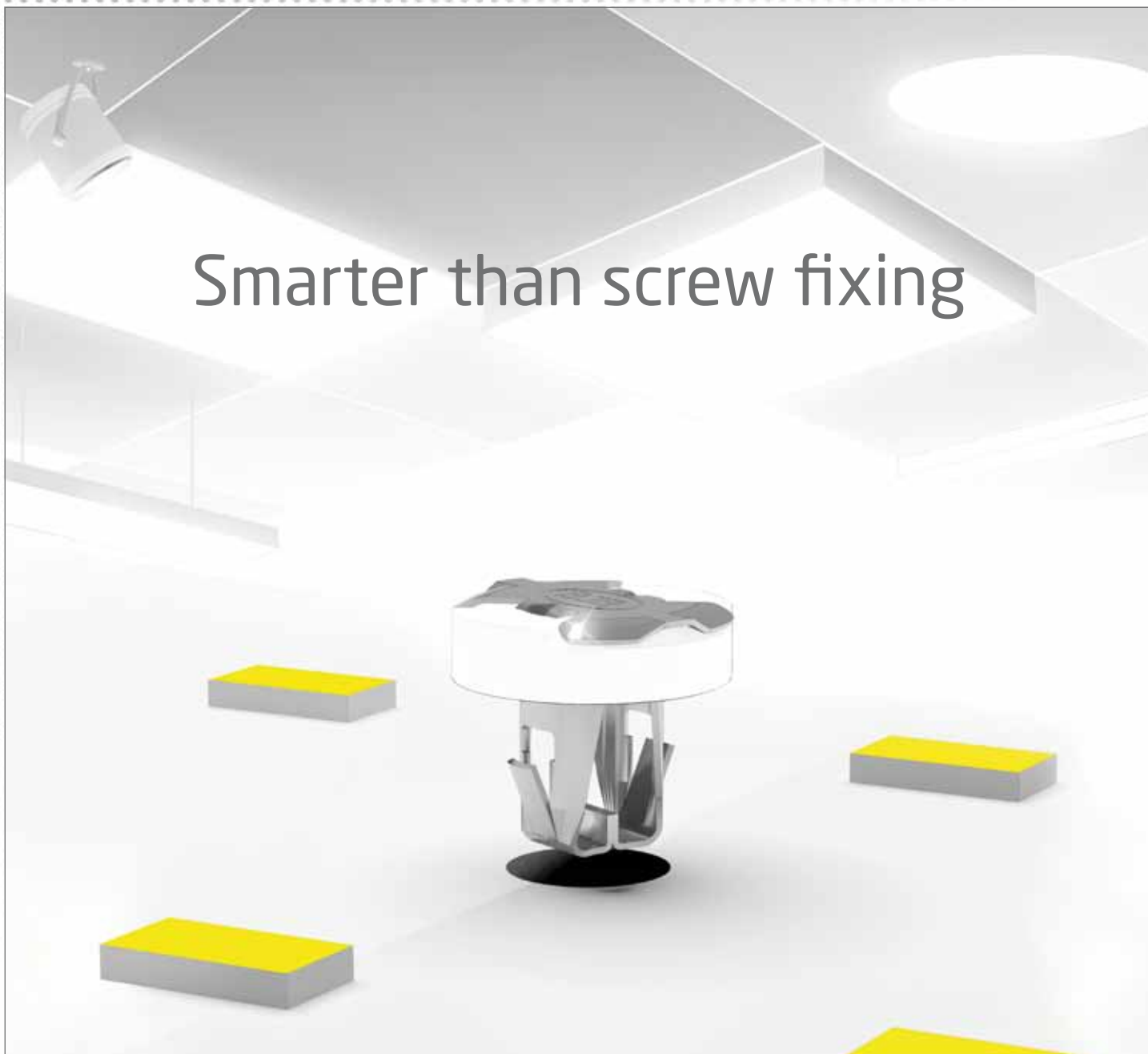

BJB///OEM-Line

P2F - Push to Fix - Fixing element
for mounting PCBs



Your Connection to Light