

## LED - Lighting and connection technology

Reflectors for connectors 47.360

**47.935**  
**47.360**

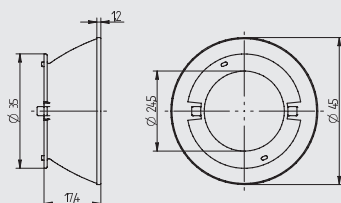

pkg.	wt.	part no.
---	3.5 g	<b>47.935.-303.56</b>

### Reflector

For use with spotlight connectors 47.360.1xxx with  $\varnothing$  35 mm

Twist and lock fixing

- Reflector can only be used when the connector is fixed with Push-to-Fix (P2F) **28.902.-102.10** for blind holes or with lense head screws M3 and locking washer

CAD

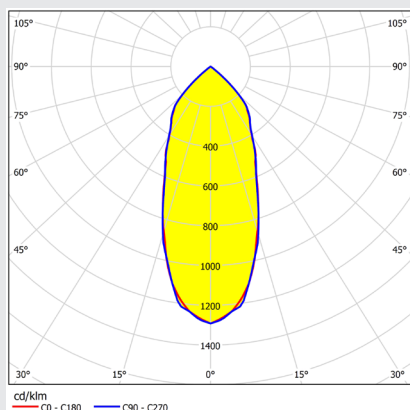

Citizen CLU038

FWHM: 42.6°

Efficiency: tbc

Connector **47.360.1010.50**



Verdrahtung alternativ  
wiring alternative

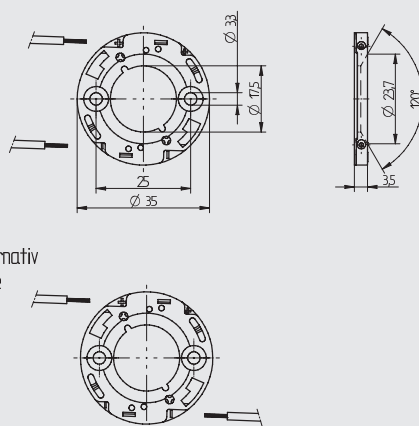

pkg.	wt.	part no.
441	2.4 g	<b>47.360.1010.50</b>

### Connector for COB LEDs.

Screw fixing

Alternativ with Push-to-Fix (P2F) for blind holes  
**28.902.-102.10**

Material: Housing: PPA

Cover: PBT

Contacts: CuSn

Rating: 3A / 60 V DC

- With integrated CoB holder and interface for reflectors **47.935** and optics **35.201**
- Easy pre-assembly of LED
- Screw fixing: for screws M3 and locking washer
- Max. torque for screw fixing 0.5 Nm
- Strip length: 8+1 mm
- Polarity symbols of connector and LED must be observed in assembly
- Specification of LED manufacturer must be observed
- In a series connection of LED modules, the air gap and creepage distances has to be sized that each module covers the total voltage of the series connection

# LED - Lighting and connection technology

Reflectors for connectors 47.360

**47.935**  
**47.360**

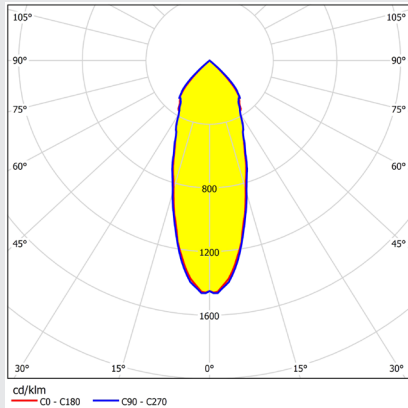

Citizen CLU028

FWHM: 36.6°

Efficiency: 92%

Connector **47.360.1020.50**

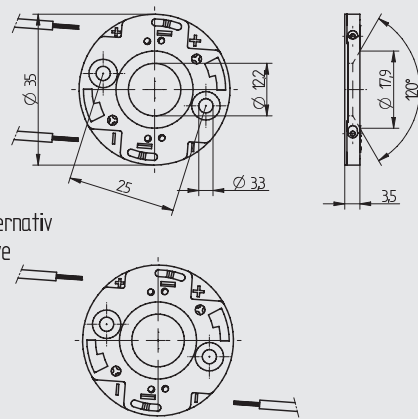

pkg.	wt.	part no.
441	2.8 g	<b>47.360.1020.50</b>

## Connector for COB LEDs.

Screw fixing  
Alternativ with Push-to-Fix (P2F) for blind holes  
**28.902.-102.10**

Material: Housing: PPA  
Cover: PBT

Contacts: CuSn  
Rating: 3A / 60 V DC

- With integrated CoB holder and interface for reflectors **47.935** and optics **35.201**
- Easy pre-assembly of LED
- Screw fixing: for screws M3 and locking washer
- Max. torque for screw fixing 0.5 Nm
- Strip length: 8+1 mm
- Polarity symbols of connector and LED must be observed in assembly
- Specification of LED manufacturer must be observed
- In a series connection of LED modules, the air gap and creepage distances has to be sized that each module covers the total voltage of the series connection

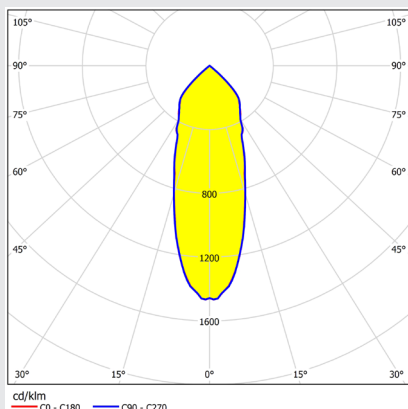

Cree CXA 1512

FWHM: 34.8°

Efficiency: 92.3%

Connector **47.360.1030.50**

pkg.	wt.	part no.
441	2.4 g	<b>47.360.1030.50</b>

**Connector for COB LEDs.**

Screw fixing

Alternativ with Push-to-Fix (P2F) for blind holes

**28.902.-102.10**

Material: Housing: PPA

Cover: PBT

Contacts: CuSn

Rating: 3A / 60 V DC

- With integrated CoB holder and interface for reflectors **47.935** and optics **35.201**
- Easy pre-assembly of LED
- Screw fixing: for screws M3 and locking washer
- Max. torque for screw fixing 0.5 Nm
- Strip length: 8+1 mm
- Polarity symbols of connector and LED must be observed in assembly
- Specification of LED manufacturer must be observed
- In a series connection of LED modules, the air gap and creepage distances has to be sized that each module covers the total voltage of the series connection

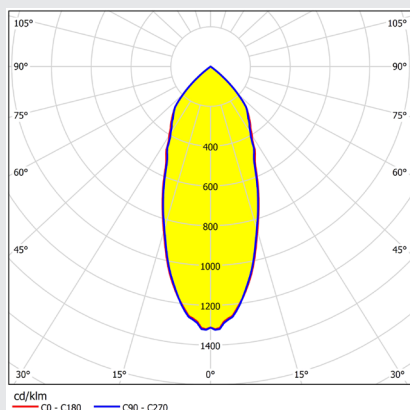
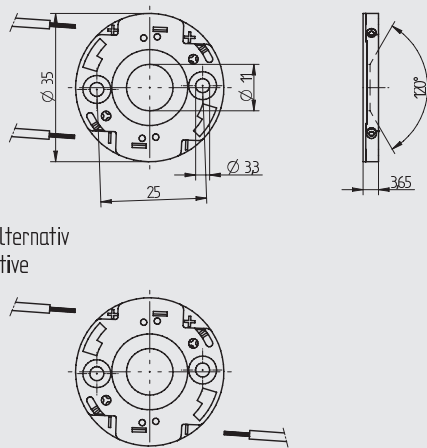
Verdrahtung alternativ  
wiring alternative

Cree CXA 1820

FWHM: 42.2°

Efficiency: 91.9%

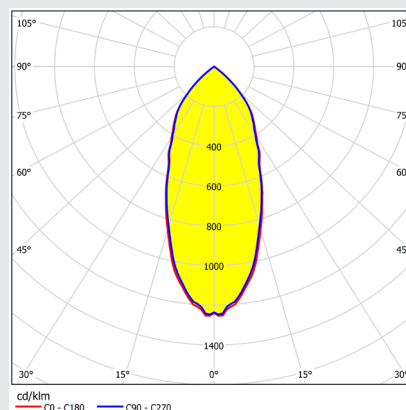
Connector **47.360.1040.50**

Cree CXA 1830

FWHM: 44.4°

Efficiency: 91.7%

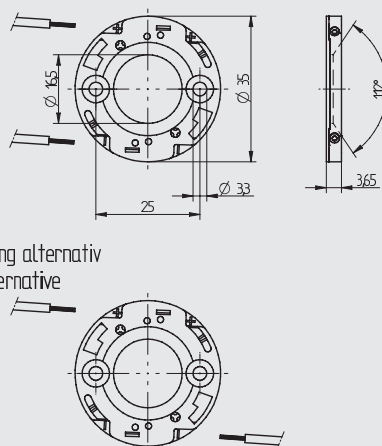
Connector **47.360.1040.50**Verdrahtung alternativ  
wiring alternative

pkg.	wt.	part no.
441	2.7 g	<b>47.360.1040.50</b>

**Connector for COB LEDs.**

Screw fixing

Alternativ with Push-to-Fix (P2F) for blind holes

**28.902.-102.10**

Material: Housing: PPA

Cover: PBT

Contacts: CuSn

Rating: 3A / 60 V DC

- With integrated CoB holder and interface for reflectors **47.935** and optics **35.201**
- Easy pre-assembly of LED
- Screw fixing: for screws M3 and locking washer
- Max. torque for screw fixing 0.5 Nm
- Strip length: 8+1 mm
- Polarity symbols of connector and LED must be observed in assembly
- Specification of LED manufacturer must be observed
- In a series connection of LED modules, the air gap and creepage distances has to be sized that each module covers the total voltage of the series connection