

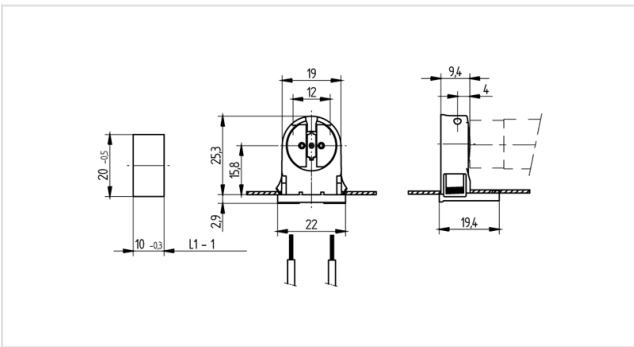

Technik für Licht
Komponenten · Optik · Automation

26.620.2004

Linear Fluorescent Lampholders: General Applications
G5 (T5): Push-Through Lampholders



Part no.:

26.620.2004.51



0,5 - 1,0 mm²



T 130

Tm 110



0,5 - 1,5



0,5 - 1,0 mm²

Description

- For enclosed cut-outs: 10 x 20 mm
- A pair of lampholders provides a lamp length tolerance compensation of 2 mm

Symbol value:	18 AWG 0.5 - 1.0 mm ²
Product name:	Fluorescent lampholder G5
LED type:	G5
Symbol 1drähtige Leitungen:	0,5 - 1,0 mm ²
Mounting method 1:	Push through mount
Material:	Housing: PC Rotor: PBT
Rotor:	with
cULus file no.:	E-92235
Approval:	cULus
Front Test:	yes
Lamp center:	15.8
Material thickness:	0.5 - 1.5
T-Marking:	130
Top Test:	yes
Pkg.:	1000